

## Stoplamp Switch (70.35.42)

### Removal



**CAUTION:** The brake pedal **MUST NOT** be depressed during this operation. Failure to comply will result in damage to the stoplamp switch.

1. Remove the closing trim panel.
  - Release the clip.
  - Remove the 2 screws.
  - Disconnect the electrical connector.

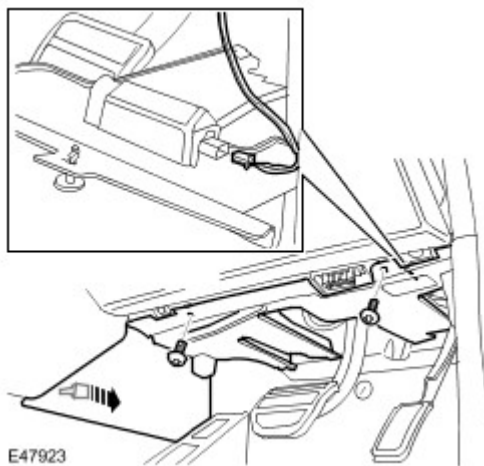

2. Remove the stoplamp switch.
  - Disconnect the electrical connector.
  - Rotate the switch clockwise.

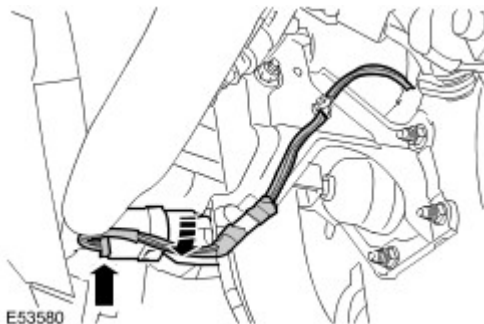

### Installation

1.



**CAUTION:** The brake pedal **MUST NOT** be depressed during this operation. Failure to comply will result in damage to the stoplamp switch.

Install the stoplamp switch.

- Rotate the switch counterclockwise.
- Connect the electrical connector.

2 .

Install the closing trim panel.

- Connect the electrical connector.
- Secure the clip.
- Tighten the screws.